



# STS -2220 Series

## SHRINK TUNNELS

Models 22, 30

**SHRINK TECH SYSTEMS**

[www.shrinktechsystems.com](http://www.shrinktechsystems.com)



### DIGITAL TEMPERATURE CONTROL

LED READ OUT WITH "COOL DOWN"  
THAT AUTOMATICALLY SHUTS  
THE SYSTEM OFF

### VARIABLE SPEED CONTROL

VARIABLE SPEED CONVEYOR CONTROL  
AND SIX HEATERS COILS  
WITH HI-LOW FAN SPEED CONTROLS

### VIEWING WINDOW

WITH LIGHTED CHAMBER  
TO MONITOR PERFORMANCE



### HEAVY DUTY LEGS

ADJUSTABLE LEG EXTENSION  
WITH LOCKING CASTERS

CONVEYOR OPTIONS:  
TEFLON MESH BELT  
STAINLESS STEEL BELT

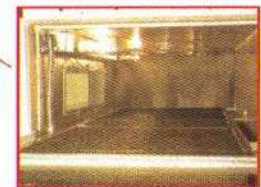

### SHRINK CHAMBER

Convection Shrink Chamber  
That Optimizes Film Capabilities

Distributed by: Miller/Bevco [www.MillerBevco.com](http://www.MillerBevco.com)  
800-821-2177/ fax: 816-561-8595  
for over 44 years offering Unique Packagaing Solutions



Manufactured  
In The U.S.A.

1226 AMBASSADOR BLVD. SAINT LOUIS, MISSOURI 63132 PH: 314.997.4259 FAX: 314.995.7006



Manufactured  
In The U.S.A.

STS SHRINK TECH SYSTEMS L.L.C.  
 1226 AMBASSADOR DRIVE  
 ST. LOUIS, MO. 63132  
 PN. 314-997-4259 / FAX 314-995-7006

SCALE: NONE

TITLE:

STS EL-TUNNEL DIMENSIONAL SPECS

DATE: 6/23/00

DRAWN BY: DARYL F.

MODEL: STS 1720/6, 2220/6, 3020/6

SHEET NO.: 1 OF 1

PWR. REQ. 220v 3ph. 60amps.

MODEL	A	B	C	D	E	F	G	H
STS 1720/6	72"	96"	35-38"	58"-61"	65"-68"	27"	20"	20"
STS 2220/6	72"	96"	35-38"	58"-61"	65"-68"	32"	25"	20"
STS 3020/6	72"	96"	35-38"	58"-61"	65"-68"	40"	32"	20"

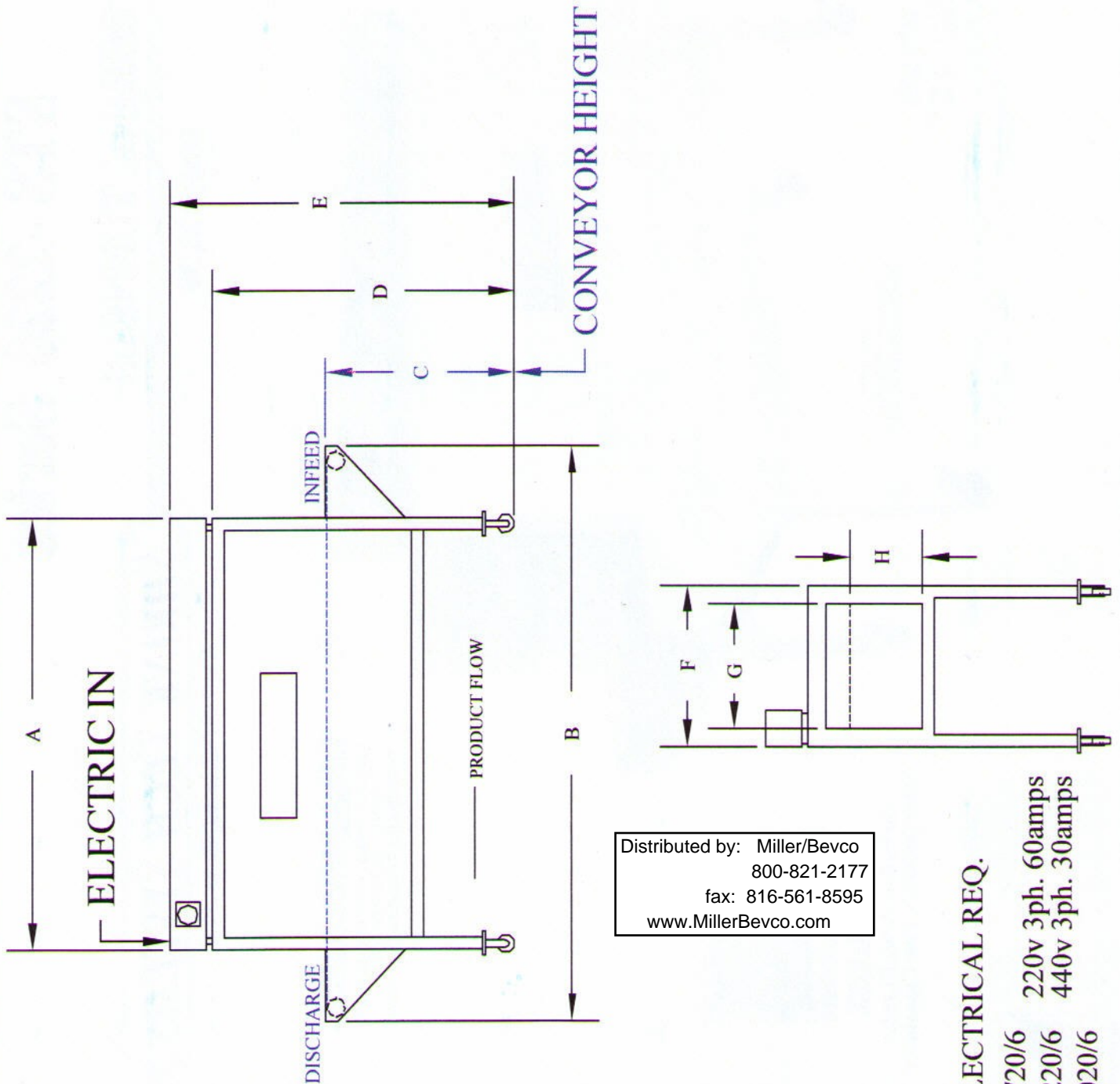

Distributed by: Miller/Bevco  
 800-821-2177  
 fax: 816-561-8595  
 www.MillerBevco.com

**ELECTRICAL REQ.**  
 1720/6 220v 3ph. 60amps  
 2220/6 440v 3ph. 30amps  
 3020/6